

NAUTITECH 40 OPEN
TECHNICAL STANDARD SPECIFICATIONS
AUGUST 11TH 2021



TECHNICAL DATAS

Length overall	11,98 m / 39'3"
Length waterline	11,94 m / 39'2"
Beam overall	6,91 m / 22'7"
Draft	1,35 m / 4'4"
Unloaded weight (approx.)	8,5 t / 18 739 lbs
Engine, drive	VP D2-30, Saildrive
Engine power	2 x 30 hp
Fuel tank	2 x 200 L / 2 x 53 gal
Water tank	2 x 300 L / 2 x 79 gal
Cabins - Heads, standard	3 or 4 - 2
Berths, standard version	6 or 8
Full batten mainsail, standard	63 m ² / 678 sq ft
Self-tacking jib, standard	28 m ² / 301 sq ft
Height of mast above water line (approx.)	20,05 m / 65'8"
Architect	Marc Lombard
Interior Design	Roseo Design
CE-Certification Category A (10 Pers.)	
CE-Certification Category B (10 Pers.)	
CE-Certification Category C (22 Pers.)	
CE-Certification Category D (22 Pers.)	



CONSTRUCTION

Hull and Deck made of fibreglass and polyester sandwich infusion-BAVARIA VacuTec process	■
Hull and Deck in gelcoat white	■
Coachroof in gelcoat white & grey decoration	■
Gold stripe on hull	■
Keel in GRP laminated and bonded to hull	■
4 x Double Hull windows including opening porthole	■
2 x Hull windows including opening porthole	■

RIG AND DECK HARDWARE

Aluminium deck stepped mast, anodised, with two spreaders sets	■
Aluminium boom, anodised	■
Anodized aluminium forward front beam	■
Running rigging	■
Mainsheet traveller on the coachroof	■
4 x Lewmar Evo aluminium winches 2-gear, self-tailing , 3 in cockpit, 1 at mast foot	■
2 x Winches handles and pockets	■

SAILS

Full batten mainsail (3 reef lines), Dacron	■
Self-tacking Solent in Dacron, incl. UV protection (Grey)	■

DECK/ STERN PLATFORM

Guardrail on hull sides with stainless steel wires	■
2 x Forward pulpits with seats in inox	■
6 x Mooring cleats, aluminium	■
Anodised aluminium forward beam with integrated anchor roller	■
Two net lashed to hull and front beam	■
Bow anchor locker and storage	■
8 x openable deck hatches (1 additionnal in the 3 cabin version)	■

PROPULSION / STEERING

2 x 30hp diesel engines Volvo Penta (Saildrive)	■
2 x 3-blade fixed aluminium propellers	■
Two helmstand with compass and stainless wheels, leather covered	■
GRP rudders with stainless steel stock	■
Emergency tiller	■
Access to engine room via transom hatches	■

ELECTRICAL MANAGEMENT SYSTEM

12 v electrical panel in the saloon portside	■
Alternators 115Ah (1 x per engine)	■
1 battery per engine 12V/90Ah	■
Battery for service 1 x 12V/140Ah	■
Electrical switch for batteries (service and engines)	■

LIGHTS

LED navigation lights and anchor light	■
Spot LED ceiling lights in cabins, bathrooms	■
Ceiling LED strips ceilinglights in saloon, cockpit and cabins	■

PLUMBING

Electric and manual bilge pumps in both hulls	■
Electric bilge pumps in both engine compartments	■
2 x 300L freshwater tanks	■
Freshwatersystem with electrical pressure pump	■
Warm water boiler via engine-cooling, 40L	■

COCKPIT / TRANSOM

- Spacious open style cockpit, 2 large benches on starboard and portside
- Aft bench with storage
- Double sliding door to salon
- Teak grating over cockpit drainage
- Large cockpit lockers
- Aft pushpits
- Foldable bathing ladder on starboard



COACHROOF

- 2 stainless steel handrails on coachroof
- Top zenithal window in coachroof



INTERIOR LAYOUTS

Available Versions

4 Cabins

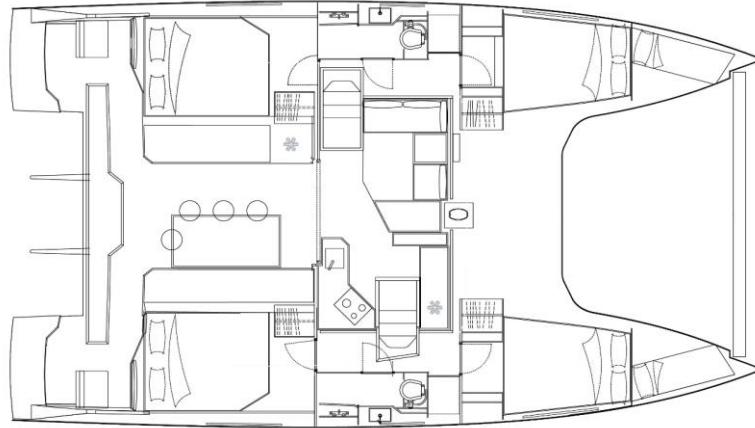

3 Cabins - Owner Version



Generalities

- Interior woodwork in Alpi White oak
- Resopal Elm Flooring
- GRP - Quartz Grey
- Headliner Silvertex ICE

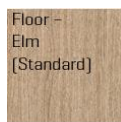

Saloon

Comfortable saloon area with modern lounge style sofas	■
Chart table, height adjustable with instrument console	■
Storage under the seats	
Fabric upholstery	■
Stainless steel handrail at companionway	
LED reading lights at the chart table	■
Central storage drawer for bottles	■
Deckhouse windscreen with 2 integrated hatches	
2 x opening roof hatches	■

Galley

Multiple storage cupboards	■
Large white worktop	■
Refrigerator 130L 12V in front galley	
Aft galley with :	■
- Gas oven	■
- 3 burner gas stove	■
- Double sink with mixer tap	■
- Waste bin	■
Overhead locker in galley, starboard	■

Cabins

Aft cabins with Double bed (160*200cm)	■
Forward cabins with Double bed (150*195cm)	■
Mattresses Light Grey with washable cover	■
Wood finish at bed front	■
Underbed storage	■
Storage locker in hull passageway	■
Double hull windows in each cabin	■
Side lining around the window White	■
Head Side, Liners, Bed Surround, Head Board ICE and Macadamia silververtex	■
Several spacious lockers and shelves for storage	■
LED reading lights headboard	■
Opening porthole in aft cabins above bed heads	■

Owner Cabins equipment (in addition to above cabin description)

Access from the saloon through a sliding door	■
Working area : Fold down desk with seat	■
Shelf on outer side of hull	■
Large lockers with three doors	■

Head stb

Sink with mixing tap	■
Black worktop	■
Cabinet for storage	■
Towel rail	■
Mirror	■
Holding tank 45L (one per hull)	■
Pump-toilet, manual	■
Opening portlight in hull window	■
Opening deck hatch	■

Owner head

Separate shower cabin	■
Black worktop	■
Cabinet for storage	■
Mirror	■
Towel rail	■
Sink with mixing tap	■
Holding tank 45L (one per hull)	■
Manual pump toilet, disposal via seacock	■
Opening portlight in hull window	■
2 x Opening deck hatch (above shower cabin and bathroom)	■

All weights and measurements are calculations based upon construction documents. The brochure is intended for advertisement only and is not part of a contract, warranty or of an offer. We reserve the right to modify or improve our products and to change specifications without notice. We are not liable for errors and printing mistakes. All rights are reserved to execute alterations in construction and equipment without notice. Aforementioned prices are recommended sales prices for deliveries ex works within 4 months of order placement. Later deliveries are subject to invoicing according to the then valid price list.



Version 03/2021 - Valid as of AUGUST 11TH 2021

Date of issue : AUGUST 11TH 2021 - the previous price list loses its validity.