

NAUTITECH 46 FLY

TECHNICAL STANDARD SPECIFICATIONS

AUGUST 11TH 2021



TECHNICAL DATAS

Length overall	13,79 m / 45'3"
Length waterline	13,71 m 45'0"
Beam overall	7,54 m / 24'9"
Draught	1,45 m / 4'9"
Unloaded weight (approx.)	11,4 t / 25.133 LBS
Engine, drive	Diesel, Saildrive
Engine power	2 x 50hp Volvo Penta
Fuel tank	2 x 300L / 2 x 79 gal
Water tank	2 x 300L / 2 x 79 gal
Cabins - Heads, standard	3 to 4
Berths, standard Version	6 to 8
Full batten mainsail, standard	69 m ² / 743 sq ft
Self-tacking jib, standard	38 m ² / 409 sq ft
Height of mast above water Line (approx.)	22,9 m / 75'2"
Architect	Marc Lombard
Interior Design	Roseo Design

CE-Certification Category A (12 Pers.)

CE-Certification Category B (12 Pers.)

CE-Certification Category C (24 Pers.)

CE-Certification Category D (24 Pers.)

CONSTRUCTION

Hull and Deck made of fibreglass and polyester sandwich infusion - VacuTec process

Hull and Deck in gelcoat white

Coachroof in gelcoat white & grey

Gold stripe on hull

Keel in GRP laminated and bonded to hull

4 x Double Hull windows including opening porthole

4 x Hull windows including opening porthole



RIG AND DECK HARDWARE

Aluminium deck stepped mast, anodised, with two spreaders sets
Aluminium boom, anodised
Running rigging
Mainsheet traveller on the coachroof
3 x Lewmar Evo aluminium winches 2-gear, self-tailing on flybridge
2 x Winches handles and pockets



SAILS

Full batten mainsail (3 reef Lines), Dacron
Self-tacking Solent in Dacron, incl. UV protection strip



DECK/ STERN PLATFORM

Guardrail on hull sides with stainless steel wires
2 x Forward pulpits
6 x Mooring cleats, aluminium
Anodised aluminium forward beam
Polyester safety net laced to hull and front beam
Bow anchor locker and storage
10 x openable deck hatches (1 additionnal in the 3 cabin Version)
Aft pushpits
2 x stainless steel handrails on stern
2 x Engine compartment hatches
Foldable bathing ladder on starboard



COCKPIT / TRANSOM

Spacious open style cockpit, 2 large benches on starboard and portside
Teak grating over cockpit drainage
Storage Locker
3 x large cockpit lockers
Liferaft locker in the aft beam



FLYBRIDGE

Access from cockpit via stairs on portside
Helm station with compass and stainless steel leather covered steering wheel
Electric engine throttle
Helmsman seat with foldable backrest
Rope bags
U-shaped settee
Adjustable sunbed backrest
Stainless steel handrail around flydeck
2 x stainless steel handrails on coachroof
Communication porthole between fly & salon



PROPULSION / STEERING

Soundproofing in engine compartments
2 x 50hp diesel engines Volvo Penta (Saildrive)
Diesel gauge
Alternators 115Ah (1 x per engine)
2 x 3-blade fixed aluminium propellers
GRP rudders with stainless steel stock
Emergency tiller



ELECTRICAL MANAGEMENT SYSTEM

1 x 12V / 140Ah services batterie
2 x 12V / 90Ah engine batteries (no maintenance)
12V Electrical panel at companion-way Portside
Gauge for service battery bank



LIGHTS

LED navigation lights and anchor Light
LED ceiling lights in cabins, bathrooms, saloon and cockpit



PLUMBING

2 x 85L holding tanks (one per hull / 65L in owner cabin)
2 x 300L freshwater tanks
Warm water boiler via engine-cooling, 60L
Pressurised water system
Indicator for freshwater
Electric and manual bilge pumps in both hulls
Electric bilge pumps in both engine compartments



INTERIOR LAYOUTS

Available Versions

4 Cabins

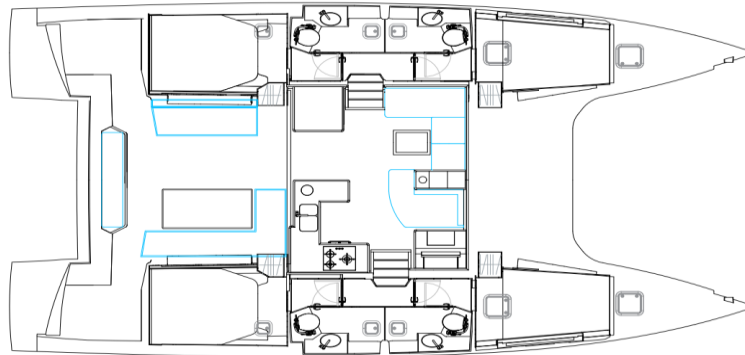

3 Cabins - Owner Version

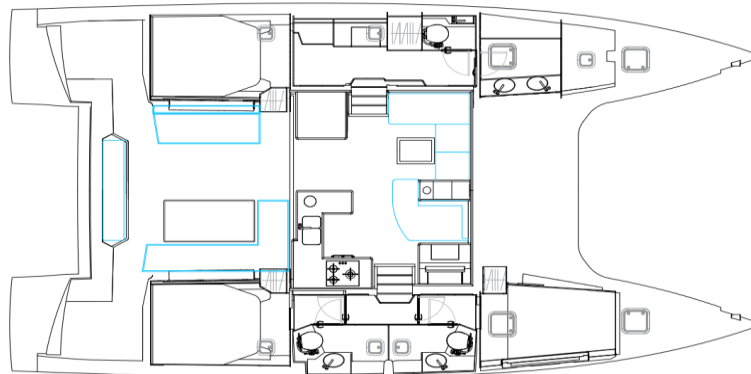

Generalities

Interior woodwork in walnut
Light walnut flooring
GRP - White
Ceiling liner Silvertex ICE
Vertical roof frame, black
Horizontal roof top frame, white plywood
Saloon baseboard, black

Saloon

Comfortable saloon area with a lounge style sofa on port
Large daybed on starboard with storage (1 locker & 1 drawer)
Storage under the seats
Fabric upholstery
Mast pillar black leather covered
Stainless steel handrail
Double sliding doors, Lockable
Deckhouse windscreen with 2 integrated hatches



Galley

Numerous storage cupboards
Large worktop (standard HPL compact white)
2-drawer stainless steel fridge, 182L portside
4 burner gas stove
Separate Gas oven
Double sink with mixer tap
Waste bin



Cabins

Aft cabins with Double bed (160*200cm)
Forward cabins with Double bed (140/165*200cm)
Mattresses light grey with washable cover
Fabric covered finish at bed front
Underbed drawer
Several lockers and shelves for storage
Wall unit
Shelves onboard side
Side lining Silververtex ICE
12V LED reading lights headboard
Opening portlight in hull window (1 per cabin)
Opening deck hatch (1 per cabin)
Opening porthole in aft cabins above bed heads



Owner Cabin equipment (in addition to above cabin description)

Access from the saloon through a sliding door
Working area : desk with seat
Large lockers with three doors
Opening deck hatch



Head (1 per cabin)

Separate shower cabin (incl. mixing tap and support)
Sink with mixing tap
Black worktop (standard HPL compact)
Cabinet for storage
Towel rail
Mirror
Pump-toilet, manual
Opening portlight
Opening deck hatch



Owner head

Separate shower cabin (incl. mixing tap and support)
Double sink with mixer tap
Large cabinets for storage
Black worktop (standard HPL compact with kerrock fiddle)
Mirrors with integrated storage
Towel rail
Separate toilet
Pump toilet, manual
Opening portlight
2 x Opening deck hatches



Passage way

Storage cupboards



All weights and measurements are calculations based upon construction documents. The brochure is intended for advertisement only and is not part of a contract, warranty or of an offer. We reserve the right to modify or improve our products and to change specifications without notice. We are not liable for errors and printing mistakes. All rights are reserved to execute alterations in construction and equipment without notice. Aforementioned prices are recommended sales prices for deliveries ex works within 4 months of order placement. Later deliveries are subject to invoicing according to the then valid priceList.