



C50

BAVARIA YACHTS

TECHNICAL DATA (approx.)

C50

| | | |
|------------------------------------------------|-----------------------|-------------------------|
| Length over all | 15,43 m | 50,62 ft |
| Length over all incl. bowsprit | 15,98 m | 52,42 ft |
| Length hull | 14,99 m | 49,17 ft |
| Length waterline | 14,28 m | 46,85 ft |
| Beam of hull | 5,00 m | 16,40 ft |
| Draught standard | 2,30 m | 7,54 ft |
| Draught option | 1,85 m | 6,06 ft |
| Ballast standard | 4.206 kg | 9.272 lb |
| Ballast option | 4.363 kg | 9.618 lb |
| Displacement with deep keel 2,3 m | 15.423 kg | 34.001 lb |
| Displacement with shallow keel 1,85 m | 16.568 kg | 36.526 lb |
| Engine (standard) | 58,8 kW / 80 PS | 58,8 kW / 80 hp |
| Engine (standard) | Yanmar 4JH80 | Yanmar 4JH80 |
| Fuel tank (approx.) | 220 L | 48,4 gal ¹⁾ |
| Water tank (approx.) | 540 L | 118,8 gal ¹⁾ |
| Sail area total (standard) | 131,2 m ² | 1412,2 sq.ft |
| Mainsail (standard) | 75,2 m ² | 809,4 sq.ft |
| Mainsail (furling mast, vertical full battens) | 69,5 m ² | 748,7 sq.ft |
| Jib | 56,0 m ² | 602,7 sq.ft |
| Genoa | 63,5 m ² | 683,5 sq.ft |
| Gennaker | 194,0 m ² | 2088,2 sq.ft |
| Code 0 | 105,0 m ² | 1130,2 sq.ft |
| Mast length (max.) from waterline excl. Windex | 23,25 m | 76,28 |
| I | 20,00 m | 65,61 ft |
| J | 5,77 m | 18,93 ft |
| P | 19,25 m | 63,15 ft |
| E | 6,66 m | 21,85 ft |
| Cabins | 3/5 | 3/5 |
| Head | 3/4 | 3/4 |
| CE category | A12 / B16 / C18 | A12 / B16 / C18 |
| Design | Cossutti Yacht Design | |
| BASE PRICE EX WORKS (EXCL. VAT) – C50 HOLIDAY | 390.400,00 € | |
| BASE PRICE EX WORKS (EXCL. VAT) – C50 STYLE | 406.350,00 € | |

¹⁾ [gal] imperial

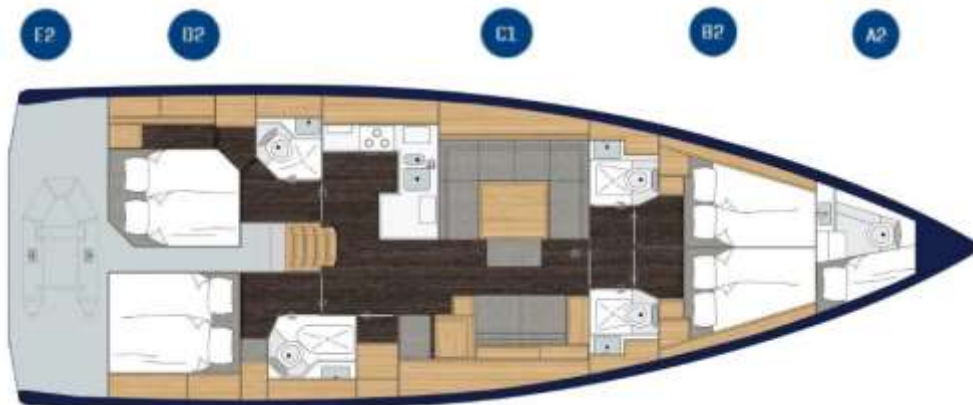
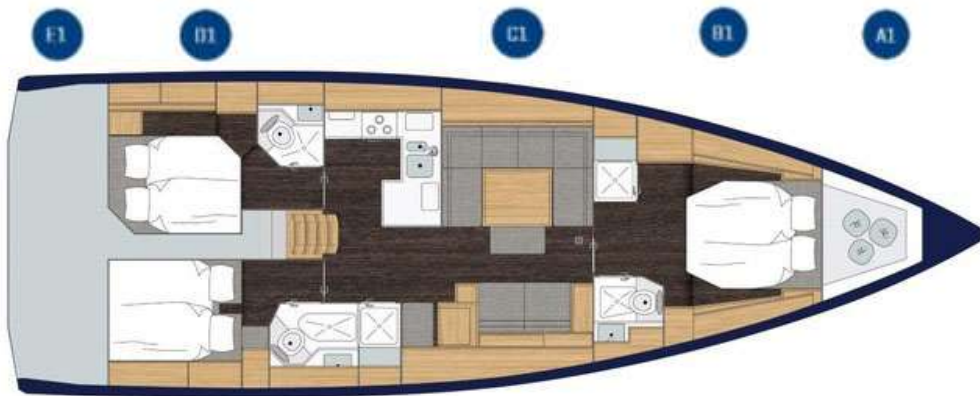

| TRIM LEVEL EQUIPMENT | HOLIDAY | STYLE | C50 |
|-----------------------------------------------------------|---------|-------|-----|
| INTERIOR STYLING | | | |
| Headboard, fabric covered, in forward cabin (B1) | | ■ | |
| Bed frames, fabric covered, in front and aft cabins | | ■ | |
| Ceiling panels, fabric covered, in salon | | ■ | |
| Chart table, leather covered | | ■ | |
| Handrails, stainless steel, leather covered | | ■ | |
| COCKPIT & DECK | | | |
| Rope storage boxes, at helm position | | ■ | |
| INTERIOR EQUIPMENT | | | |
| Reading lights incl. USB charger, salon and cabins | | ■ | |
| Handrail on ceiling in stainless steel with leather cover | | ■ | |

| OPTIONAL PACKAGES | HOLIDAY | STYLE | Price excl. VAT | C50 |
|---------------------------------------------------------------------------------------------------------------------------------------------------------------------------------------------------------------------------------------------------------------------------------------------------------------------------------------------------------------------------------------------------------------------|---------|-------|-----------------|--------------------------|
| SAIL READY PACK "HOLIDAY" (HP) | | | | |
| PACKAGE CONTENTS | ○ | — | 16.250,00 € | <input type="checkbox"/> |
| Battery extension, 4 x service batteries 95 Ah / 12 V, AGM incl. charger 60A, (instead of 2 x service batteries 95 Ah / 12 V, AGM; charger 40 A) Guard rail exit, both sides Anchor windlass, electrical Anchor, 25 kg, incl. chain (10 mm, 75 m), galvanized Courtesy lights in salon Curtains for coachroof and hull windows Blinds incl. mosquito nets for hatches in salon and cabins | | | | |
| Deck vents, 2 x, on deck hatches LED lights in salon and cabins Mooring kit (8 fenders and 4 mooring lines) Reading lights incl. USB charger, salon and cabins Handrail on ceiling in stainless steel Rope storage boxes, bb and stb at helm position Stainless steel bow protection Cockpit shower with cold and warm water | | | | |
| UPGRADES SAIL READY PACK "HOLIDAY" (HP) | | | | |
| Bow thruster, tunnel, incl. additional battery 2 x 95 Ah / 12 V, AGM | ○ | — | 8.190,00 € | <input type="checkbox"/> |
| Lithium Battery extension, 4 x 150 Ah/12V LiFePO4 batteries instead of AGM service batteries | ○ | — | 11.250,00 € | <input type="checkbox"/> |
| Anchor, 25 kg, incl. chain (10 mm, 75 m) stainless steel | ○ | — | 4.920,00 € | <input type="checkbox"/> |
| Anchor windlass with capstans | ○ | — | 1.350,00 € | <input type="checkbox"/> |
| SAIL READY PACK "STYLE" (SP) | | | | |
| PACKAGE CONTENTS | — | ○ | 28.750,00 € | <input type="checkbox"/> |
| Bow thruster, tunnel, incl. additional battery 2 x 95 Ah / 12 V, AGM Teak on cockpit bottom Battery extension, 4 x service batteries 95 Ah / 12 V, AGM incl. charger 60A, (instead of 2 x service batteries 95 Ah / 12 V, AGM; charger 40 A) Guard rail exit, both sides Anchor windlass, electrical Anchor, 25 kg, incl. chain (10 mm, 75 m), galvanized Courtesy lights in salon and in cockpit | | | | |
| Curtains for coachroof and hull windows Blinds incl. mosquito nets for hatches in salon and cabins Deck vents, 2 x, on deck hatches LED lights in salon and cabins Mooring kit (8 fenders and 4 mooring lines) Ambient lights in salon and cabins, dimmable Extractor hood in galley Cockpit shower with cold and warm water | | | | |
| UPGRADES SAIL READY PACK "STYLE" (SP) | | | | |
| Bow thruster, retractable, incl. additional battery 2 x 95 Ah / 12 V, AGM | — | ○ | 6.780,00 € | <input type="checkbox"/> |
| Lithium Battery extension, 4 x 150 Ah/12V LiFePO4 batteries instead of AGM service batteries | — | ○ | 11.250,00 € | <input type="checkbox"/> |
| Esthec on cockpit bottom | — | ○ | 800,00 € | <input type="checkbox"/> |
| Anchor, 25 kg, incl. chain (10 mm, 75 m) stainless steel | — | ○ | 4.920,00 € | <input type="checkbox"/> |
| Anchor windlass with capstans | — | ○ | 1.350,00 € | <input type="checkbox"/> |

| NAVIGATION PACKAGES | | | | | |
|---------------------------------------------------------------------------------------------------------------------------------------------------------------------------------------------------------------------------------------------------------------------------------------------------------------------------------------------------------------------------------------------------------|-------------------------------------------------------------------------------------------------------------------------------------------------------------------------------------------------------------------------------------------------------------------------------------|---|---|-------------|--------------------------|
| NAVIGATION "BASIC" PACKAGE | | ○ | — | 12.110,00 € | <input type="checkbox"/> |
| Instrument console (1 x per helm station) Display, 2 x B&G Triton ² digital displays in cockpit; B&G Wind vane; DST800 Transducer for speed, depth and temperature Multi function display, B&G Zeus ³ S 9" with integrated GoFree™ Wi-Fi; all- weather touch screen and expanded keypad | VHF, B&G V60 with integrated AIS Receiver at chart table Autopilot B&G, incl. compass Autopilot B&G, control unit at helmstation stb Autopilot B&G, wireless remote control WR10 | | | | |
| NAVIGATION "ADVANCED" PACKAGE | | ○ | ○ | 16.060,00 € | <input type="checkbox"/> |
| Instrument console (1 x per helm station) Display, 2 x B&G Triton ² digital displays in cockpit; B&G Wind vane; DST800 Transducer for speed, depth and temperature Multi function display, 2 x B&G Zeus ³ S 9" with integrated GoFree™ Wi-Fi; all-weather touch screen and expanded keypad, one per helm station | VHF, B&G V60 with integrated AIS Receiver at chart table VHF, B&G H60 wireless handset Autopilot B&G, incl. compass Autopilot B&G, control unit at helmstation stb Autopilot B&G, wireless remote control WR10 | | | | |
| NAVIGATION "PREMIUM" PACKAGE | | — | ○ | 26.150,00 € | <input type="checkbox"/> |
| Instrument console (1 x per helm station) Display, 2 x B&G H5000 graphic displays (1 x per helmstation); B&G Wind vane; DST800 Transducer for speed, depth and temperature Multi function display, 2 x B&G Zeus ³ S 12" with integrated GoFree™ Wi- Fi; all-weather touch screen and expanded keypad, one per helmstation NMEA engine information interface for chart plotter | VHF, B&G V60 with integrated AIS Receiver at chart table VHF, B&G H60 wireless handset Autopilot B&G, incl. compass Autopilot B&G, H5000 control unit (1 x per helmstation) Autopilot B&G, Triton Edge Sailing Processor Autopilot B&G, wireless remote control WR10 | | | | |
| UPGRADES NAVIGATION PACKAGE | | | | | |
| Multi function display, B&G Zeus ³ S 9" with integrated GoFree™ Wi-Fi; all-weather touch screen and expanded keypad, at chart table | | ○ | ○ | 3.630,00 € | <input type="checkbox"/> |
| Radar B&G Halo 20+ | | ○ | ○ | 3.840,00 € | <input type="checkbox"/> |
| Depth sounder, B&G ForwardScan | | — | ○ | 1.760,00 € | <input type="checkbox"/> |
| AIS transponder, B&G NAIS-500 class B transponder | | ○ | ○ | 1.530,00 € | <input type="checkbox"/> |
| NMEA engine information interface for chart plotter (included in Navigation "PREMIUM" Package) | | ○ | ○ | 1.280,00 € | <input type="checkbox"/> |
| ENTERTAINMENT PACKAGE | | | | | |
| PACKAGE CONTENTS | | ○ | ○ | 2.980,00 € | <input type="checkbox"/> |
| Radio entertainment system Fusion MS-RA770 Apollo Marine with DAB+ and 2 speakers in salon | Fusion ERX400 Apollo remote control with 2 speakers in cockpit | | | | |
| UPGRADES ENTERTAINMENT PACKAGES | | | | | |
| ENTERTAINMENT PACKAGE "OWNER" Radio entertainment system Fusion MS-R670 and 2 speakers in foreship cabin (only with B1) | | — | ○ | 1.230,00 € | <input type="checkbox"/> |
| TV preparation in salon, incl. TV lift system | | ○ | ○ | 1.990,00 € | <input type="checkbox"/> |

| INDIVIDUAL OPTIONS | | HOLIDAY | STYLE | Price excl. VAT | C50 |
|---------------------------------------------------------------------------------------------------------------------------------------------------------------------------------------------------------------------------------------------------------------------------------------------------|---|-----------------------------------------------------------------------------------------------------------------------------------------------------------------------|-------------|--------------------------|-----|
| HULL / KEEL | | | | | |
| STANDARD | | | | | |
| Hull in sandwich construction | | Keel, L-shape, cast iron, draft 2,30 m | | | |
| OPTIONS | | | | | |
| Hull colour, white | ■ | ■ | Standard | <input type="checkbox"/> | |
| Hull colour silk grey with hull stripe white | ○ | ○ | 5.670,00 € | <input type="checkbox"/> | |
| Hull stripe, dark blue | ■ | ○ | 1.390,00 € | <input type="checkbox"/> | |
| Hull stripe, silk grey | ○ | ■ | 1.390,00 € | <input type="checkbox"/> | |
| Hull stripe, dark grey | ○ | ○ | 1.390,00 € | <input type="checkbox"/> | |
| Hull stripe, jet black | ○ | ○ | 1.390,00 € | <input type="checkbox"/> | |
| Keel, L-shape, cast iron, draft 1,85 m | ○ | ○ | 3.580,00 € | <input type="checkbox"/> | |
| PROPULSION & STEERING SYSTEM | | | | | |
| STANDARD | | | | | |
| Diesel engine, 59 kW / 80 hp, sail drive 3 blade fixed propeller Engine throttle, mechanical, mounted on helm station starboard | | Twin wheel steering system GRP single rudder with aluminum stock Steering wheel, stainless steel with leather cover | | | |
| OPTIONS | | | | | |
| Propeller, folding, 3 blades | ○ | ○ | 2.580,00 € | <input type="checkbox"/> | |
| Stern thruster incl. 2 x 95 Ah battery, retractable (only with bow thruster retractable) | – | ○ | 15.750,00 € | <input type="checkbox"/> | |
| Steering wheel, composite, black or white | ○ | ○ | 1.870,00 € | <input type="checkbox"/> | |
| Steering wheels covers | – | ○ | 670,00 € | <input type="checkbox"/> | |
| STANDING AND RUNNING GEAR | | | | | |
| STANDARD | | | | | |
| Sportmast, deck stepped, 2 spreader, aluminum Jib furling system, above deck, manual Rodkicker Backstay adjuster, mechanical | | Midboom sheeting system Elvström Cruisetech Dacron - Mainsail, short battened with 2 reefs - self tacking jib, no battens Halyard winches, 2 x, size 55, manual | | | |
| OPTIONS SPORTMAST | | | | | |
| Elvström Cruisetech Dacron - Mainsail, full battened with 2 reefs and MDS slider (replacing standard main sail) | ○ | ○ | 1.500,00 € | <input type="checkbox"/> | |
| Elvström Ekko-Tech laminate - Mainsail, full battened with 2 reefs and MDS slider- self tacking jib, vertical battened | ○ | ○ | 9.700,00 € | <input type="checkbox"/> | |
| Lazy bag with lazy jacks for mainsail | ○ | ○ | 1.730,00 € | <input type="checkbox"/> | |
| OPTIONS FURLING MAST | | | | | |
| Furling mast on deck stepped 2 spreader, aluminum incl. upgrade to Cruisetech Dacron furling mainsail | ○ | ○ | 4.040,00 € | <input type="checkbox"/> | |
| Furling mast on deck stepped, electrical with 2 spreader, aluminum incl. upgrade to Cruisetech Dacron furling mainsail; jib furling system, electrical. Electrical synchronized halyard winch on ps and electrical halyard winch Selden E52, on sb Lewmar Evo 55 AEST; C57 Lewmar 65 AEST) | ○ | ○ | 31.500,00 € | <input type="checkbox"/> | |
| Intracoastal Waterway Rigging: Short-mast and mainsail furling system incl. upgrade to Cruisetech Dacron furling mainsail | ○ | ○ | 4.990,00 € | <input type="checkbox"/> | |
| Intracoastal Waterway Rigging, electrical: Short-mast and mainsail furling system, electrical, incl. upgrade to Cruisetech Dacron furling mainsail; jib furling system, electrical. Electrical synchronized halyard winch Selden E52 on ps and electrical halyard winch Lewmar Evo 55 AEST on sb. | ○ | ○ | 36.490,00 € | <input type="checkbox"/> | |
| Elvström Cruisetech Dacron UPGRADE - furling mainsail, full battened - self-tacking jib with vertical battens | ○ | ○ | 1.900,00 € | <input type="checkbox"/> | |
| Elvström Ekko-Tech laminate - furling mainsail, full battened - self-tacking jib with vertical battens | ○ | ○ | 10.500,00 € | <input type="checkbox"/> | |
| OPTIONS STANDING AND RUNNING GEAR | | | | | |
| Elvström genoa 106 % – Cruisetech Dacron (only with genoa tracks) | ○ | ○ | 5.198,00 € | <input type="checkbox"/> | |
| Elvström genoa 106 % – Ekko-Tech (only with genoa tracks) | ○ | ○ | 6.798,00 € | <input type="checkbox"/> | |
| Genoa tracks with pin stop cars | ○ | ○ | 1.800,00 € | <input type="checkbox"/> | |
| Elvström gennaker incl. snuffer and gennaker gear (halyard, sheets, blocks, halyard clutch and pad eye) | ○ | ○ | 7.800,00 € | <input type="checkbox"/> | |

| | | | | |
|-------------------------------------------------------------------------------------------------------------------------------|-----------------------|-----------------------|------------|--------------------------|
| Elvström permanent Code 0 and gear (halyard, sheets, blocks, halyard clutch and pad eye for code 0 tack / only with bowsprit) | <input type="radio"/> | <input type="radio"/> | 8.980,00 € | <input type="checkbox"/> |
| Mast step | <input type="radio"/> | <input type="radio"/> | 740,00 € | <input type="checkbox"/> |
| Spreader lights, 4 pcs. | – | <input type="radio"/> | 1.660,00 € | <input type="checkbox"/> |
| GRP bowsprit (black or white / recommended for gennaker and code 0) | <input type="radio"/> | <input type="radio"/> | 3.640,00 € | <input type="checkbox"/> |

OPTIONS WINCHES

| | | | | |
|--------------------------------------------------------|-----------------------|-----------------------|------------|--------------------------|
| Halyard winches, 2 x, size 55, electrical | <input type="radio"/> | <input type="radio"/> | 5.150,00 € | <input type="checkbox"/> |
| Genoa/gennaker/code0 winches, 2 x, size 55, manual | <input type="radio"/> | <input type="radio"/> | 3.440,00 € | <input type="checkbox"/> |
| Genoa/gennaker/code0 winches, 2 x, size 55, electrical | <input type="radio"/> | <input type="radio"/> | 8.590,00 € | <input type="checkbox"/> |

DECK FLOORING

STANDARD

Teak on cockpit benches and bathing platform

OPTIONS

| | | | | | |
|------------------------------------------------|-----------------------|-----------------------|-------------|--------------------------|----|
| Teak on cockpit bottom | <input type="radio"/> | <input type="radio"/> | 5.220,00 € | <input type="checkbox"/> | SP |
| Teak on side decks | <input type="radio"/> | <input type="radio"/> | 19.710,00 € | <input type="checkbox"/> | |
| Teak on coachroof | – | <input type="radio"/> | 7.330,00 € | <input type="checkbox"/> | |
| Esthec on cockpit benches and bathing platform | <input type="radio"/> | <input type="radio"/> | 690,00 € | <input type="checkbox"/> | |
| Esthec on cockpit bottom | <input type="radio"/> | <input type="radio"/> | 5.650,00 € | <input type="checkbox"/> | |
| Esthec on side decks | <input type="radio"/> | <input type="radio"/> | 19.750,00 € | <input type="checkbox"/> | |
| Esthec on coachroof | – | <input type="radio"/> | 7.300,00 € | <input type="checkbox"/> | |

COCKPIT & DECK

STANDARD

Deck in sandwich construction, cockpit floor, side decks and coach roof with non-slip structure
Deck flush hatches

Cockpit table with small storage, 2 x, fix
Bow fitting with anchor roller, stainless steel
Mooring cleats, 6 x, stainless steel, fix

OPTIONS COCKPIT & DECK

| | | | | | |
|---------------------------------------------------------------------------------------|-----------------------|-----------------------|------------|--------------------------|--------|
| Cockpit table with small storage, 2 x, electrical, lowerable to sun bathing area | – | <input type="radio"/> | 4.590,00 € | <input type="checkbox"/> | |
| Drawer fridge incl. compressor at wet bar, 20 L (only in combination with E2 and BBQ) | <input type="radio"/> | <input type="radio"/> | 1.690,00 € | <input type="checkbox"/> | |
| BBQ (gas) with sink and water tap in wet bar (only in combination with E2) | <input type="radio"/> | <input type="radio"/> | 2.620,00 € | <input type="checkbox"/> | |
| Guard rail exit, both sides | <input type="radio"/> | <input type="radio"/> | 1.310,00 € | <input type="checkbox"/> | HP, SP |
| Mooring cleats, 6 x, aluminum, retractable | – | <input type="radio"/> | 4.160,00 € | <input type="checkbox"/> | |
| Stainless steel bow protection | <input type="radio"/> | <input type="radio"/> | 570,00 € | <input type="checkbox"/> | HP |

OPTIONS COCKPIT UPHOLSTERY

| | | | | | |
|--------------------------------------------------------------|-----------------------|-----------------------|------------|--------------------------|--|
| Cockpit cushions incl. backrests | – | <input type="radio"/> | 3.790,00 € | <input type="checkbox"/> | |
| Cockpit cushions for lowerable tables | – | <input type="radio"/> | 570,00 € | <input type="checkbox"/> | |
| Cockpit cushions | <input type="radio"/> | <input type="radio"/> | 2.150,00 € | <input type="checkbox"/> | |
| Sun bed cushions on coachroof incl. headrest and cup holders | <input type="radio"/> | <input type="radio"/> | 2.040,00 € | <input type="checkbox"/> | |
| Sun bed cushions on foredeck incl. headrest and cup holders | <input type="radio"/> | <input type="radio"/> | 2.150,00 € | <input type="checkbox"/> | |

OPTIONS HOODS

| | | | | | |
|-------------------------------|-----------------------|-----------------------|------------|--------------------------|--|
| Bimini top | <input type="radio"/> | <input type="radio"/> | 4.710,00 € | <input type="checkbox"/> | |
| Bimini top with solar, 348 Wp | <input type="radio"/> | <input type="radio"/> | 8.650,00 € | <input type="checkbox"/> | |
| Sprayhood with handhold | <input type="radio"/> | <input type="radio"/> | 2.990,00 € | <input type="checkbox"/> | |
| Cockpit tables cover | – | <input type="radio"/> | 700,00 € | <input type="checkbox"/> | |

BATHING PLATFORM

STANDARD

Bathing platform, electric

OPTIONS

| | | | | | |
|-------------------------------------------------------------------------|-----------------------|-----------------------|------------|--------------------------|--|
| Wireless remote control for bathing platform | <input type="radio"/> | <input type="radio"/> | 1.580,00 € | <input type="checkbox"/> | |
| 12 V air compressor at transom for dinghy or toys (only with E2 Layout) | <input type="radio"/> | <input type="radio"/> | 920,00 € | <input type="checkbox"/> | |

INTERIOR LAYOUT

STANDARD

A1: Sail locker
 B1: Queen size "island" double berth, storage, separate head and shower stall
 C1: Salon incl. L shaped galley, dining area on port, lounge area and chart table on stb

D3: 2 twin cabins aft incl. head and utility room on stb
 E1: Storage space for toys and equipment under cockpit, access via cockpit floor hatch
 Companion way with washboard and sliding hatch in acrylic glass, lockable
 Salon dining table

OPTIONS

| | | | | |
|------------------------------------------------------------------------------------------------------|-----------------------|-----------------------|------------|--------------------------|
| A2: Crew cabin with sink, toilet and storage space | <input type="radio"/> | <input type="radio"/> | 7.890,00 € | <input type="checkbox"/> |
| B2: 2 Forward cabins, each cabin with double bed and storage, flex bulkhead system, 2 heads | <input type="radio"/> | <input type="radio"/> | 5.200,00 € | <input type="checkbox"/> |
| D1: 2 Aft cabins, incl. head with separate shower stall on stb | <input type="radio"/> | <input type="radio"/> | 3.210,00 € | <input type="checkbox"/> |
| D2: 2 Aft cabins, incl. bunk bed cabin on stb | <input type="radio"/> | <input type="radio"/> | 2.670,00 € | <input type="checkbox"/> |
| E2: Dinghy garage with integrated transom bench and storage/wetbar (for wetbar; option BBQ/watertap) | <input type="radio"/> | <input type="radio"/> | 4.470,00 € | <input type="checkbox"/> |
| Salon table, lowerable, electrical, convertible into double berth incl. cushion | <input type="radio"/> | <input type="radio"/> | 2.990,00 € | <input type="checkbox"/> |

INTERIOR STYLING

STANDARD

Wood color, Mahogany
 Floor, Elm
 Worktop in galley, laminated, "Brown stone"

Upholstery "Vela" in salon
 Standard mattresses for all berths

OPTIONS STYLING

| | | | | |
|--------------------------------------------------------|-------------------------------------|-------------------------------------|------------|--------------------------|
| Wood color, Mahogany | <input checked="" type="checkbox"/> | <input checked="" type="checkbox"/> | Standard | <input type="checkbox"/> |
| Wood color, American Walnut | <input type="radio"/> | <input type="radio"/> | 6.790,00 € | <input type="checkbox"/> |
| Wood color, Nordic Oak | <input type="radio"/> | <input type="radio"/> | 7.500,00 € | <input type="checkbox"/> |
| Floor, Elm | <input checked="" type="checkbox"/> | <input checked="" type="checkbox"/> | Standard | <input type="checkbox"/> |
| Floor, Wenge | <input type="radio"/> | <input type="radio"/> | 980,00 € | <input type="checkbox"/> |
| Floor, Ocean Line | <input type="radio"/> | <input type="radio"/> | 1.410,00 € | <input type="checkbox"/> |
| Worktop in galley, laminated, "Pure white stone" | <input type="radio"/> | <input type="radio"/> | 890,00 € | <input type="checkbox"/> |
| Worktop in galley, solid worktop "Staten Island Stone" | <input type="radio"/> | <input type="radio"/> | 2.470,00 € | <input type="checkbox"/> |
| Worktop in galley, solid worktop "Canvas Mist" | <input type="radio"/> | <input type="radio"/> | 2.470,00 € | <input type="checkbox"/> |

OPTIONS UPHOLSTERY

| | | | | |
|------------------------------------------------------------|-----------------------|-----------------------|------------|--------------------------|
| Upholstery "Heritage" in salon, fabric | <input type="radio"/> | <input type="radio"/> | 1.430,00 € | <input type="checkbox"/> |
| Upholstery "Opus" in salon, artificial leather | <input type="radio"/> | <input type="radio"/> | 1.530,00 € | <input type="checkbox"/> |
| Upholstery "Savoy" in salon, leather | <input type="radio"/> | <input type="radio"/> | 6.080,00 € | <input type="checkbox"/> |
| Cold foam mattress with memory top for all berths 3 cabins | <input type="radio"/> | <input type="radio"/> | 3.520,00 € | <input type="checkbox"/> |
| Cold foam mattress with memory top for all berths 4 cabins | <input type="radio"/> | <input type="radio"/> | 3.750,00 € | <input type="checkbox"/> |
| Cold foam mattress with memory top for all berths 5 cabins | <input type="radio"/> | <input type="radio"/> | 3.980,00 € | <input type="checkbox"/> |

INTERIOR EQUIPMENT – GALLEY

STANDARD

Fridge in galley, 110L, top loading

3 burner stove with oven

OPTIONS

| | | | | | |
|-----------------------------------------------------------------------------------------------------------------------------------------------------------------------------------|-----------------------|-----------------------|------------|--------------------------|----|
| Microwave, 230 V, (powered by Generator or Shore-Power) | <input type="radio"/> | <input type="radio"/> | 780,00 € | <input type="checkbox"/> | |
| Microwave preparation, 110V, (powered by Generator or Shore-Power) | <input type="radio"/> | <input type="radio"/> | 410,00 € | <input type="checkbox"/> | |
| Dishwasher drawer 230 V (not in combination with cooled and sparkling water) | <input type="radio"/> | <input type="radio"/> | 3.740,00 € | <input type="checkbox"/> | |
| Additional drawer fridge incl. Freezer unit totalling 160 L | <input type="radio"/> | <input type="radio"/> | 3.660,00 € | <input type="checkbox"/> | |
| Extractor hood in galley | <input type="radio"/> | <input type="radio"/> | 880,00 € | <input type="checkbox"/> | SP |
| Purified drinking water with UVC-LED technology in pantry | <input type="radio"/> | <input type="radio"/> | 1.350,00 € | <input type="checkbox"/> | |
| Cooled and sparkling water at the pantry tap (only with purified drinking water - not in combination with dishwasher drawer, only with 230V, powered by Generator or Shore-Power) | <input type="radio"/> | <input type="radio"/> | 2.790,00 € | <input type="checkbox"/> | |

INTERIOR EQUIPMENT – ELECTRICAL SYSTEM

STANDARD

| | |
|-------------------------------------------------------------------------------------------|-------------------------------------------------------------------------------|
| Country version EU 230 V socket in each cabin Engine battery, 1 x 96 Ah / 12 V, AGM | Service battery, 2 x 95 Ah / 12 V, AGM Battery charger, 40 Ah (3 channels) |
|-------------------------------------------------------------------------------------------|-------------------------------------------------------------------------------|

OPTIONS

| | | | | |
|------------------------------------------|-----------------------|-----------------------|-------------|--------------------------|
| Inverter 2.500 W, 230 V (true sine wave) | <input type="radio"/> | <input type="radio"/> | 3.180,00 € | <input type="checkbox"/> |
| Inverter 2.000 W, 110 V (true sine wave) | <input type="radio"/> | <input type="radio"/> | 3.180,00 € | <input type="checkbox"/> |
| Diesel generator 6.4 kW, 230 V | <input type="radio"/> | <input type="radio"/> | 23.740,00 € | <input type="checkbox"/> |
| Diesel generator 6.4 kW, 110 V | <input type="radio"/> | <input type="radio"/> | 28.190,00 € | <input type="checkbox"/> |
| Shore power 110 V | <input type="radio"/> | <input type="radio"/> | 3.910,00 € | <input type="checkbox"/> |

INTERIOR EQUIPMENT – WATER

STANDARD

| | |
|----------------------------------------------|--------------------------------|
| 40 L boiler 70 L holding tank, per toilet | Electric and manual bilge pump |
|----------------------------------------------|--------------------------------|

OPTIONS

| | | | | |
|----------------------------------------------------------------------------------|-----------------------|-----------------------|-------------|--------------------------|
| Fresh water dockside inlet | <input type="radio"/> | <input type="radio"/> | 560,00 € | <input type="checkbox"/> |
| Watermaker 100 L/h, 12 V | <input type="radio"/> | <input type="radio"/> | 16.500,00 € | <input type="checkbox"/> |
| Washing machine, 220 V (only with D3 layout) | – | <input type="radio"/> | 3.120,00 € | <input type="checkbox"/> |
| Electric toilet (1x) front cabin with fresh water flush system for B1 layout | <input type="radio"/> | <input type="radio"/> | 1.250,00 € | <input type="checkbox"/> |
| Electric toilet (2x) front cabin with fresh water flush system for B2 layout | <input type="radio"/> | <input type="radio"/> | 2.490,00 € | <input type="checkbox"/> |
| Electric toilet (2x) aft cabin with fresh water flush system for D1 or D3 layout | <input type="radio"/> | <input type="radio"/> | 2.490,00 € | <input type="checkbox"/> |
| Electric toilet (1x) aft cabin with fresh water flush system for D2 layout | <input type="radio"/> | <input type="radio"/> | 1.250,00 € | <input type="checkbox"/> |
| Grey water system, totalling 220 L | <input type="radio"/> | <input type="radio"/> | 2.590,00 € | <input type="checkbox"/> |

INTERIOR EQUIPMENT – CLIMATE CONTROL (HEATING AND AIR CONDITIONER ARE NOT COMBINABLE)

OPTIONS

| | | | | |
|-----------------------------------------------------------------------------------------------------------------------------------------|-----------------------|-----------------------|-------------|--------------------------|
| Air Conditioner, Reverse Cycle, 18.000 BTU, 2 Units for foreship cabin and aft cabins, 230 V / 110 V (with 230V: incl. 2nd shore power) | <input type="radio"/> | <input type="radio"/> | 17.100,00 € | <input type="checkbox"/> |
| Air Conditioner, Reverse Cycle, 16.000 BTU, 1 Unit for salon (incl. D2 cabin), 230 V / 110 V (with 230V: incl. 2nd shore power) | <input type="radio"/> | <input type="radio"/> | 13.100,00 € | <input type="checkbox"/> |
| Hot air heating, 8,0 kW, 2 Units for salon, foreship cabin(s) and aft cabins | <input type="radio"/> | <input type="radio"/> | 9.060,00 € | <input type="checkbox"/> |

SHIPMENT

OPTIONS

| | | | | |
|------------------------------------------------------------------------------|-----------------------|-----------------------|------------|--------------------------|
| Keel not mounted | <input type="radio"/> | <input type="radio"/> | 630,00 € | <input type="checkbox"/> |
| Steel cradle for oversea transport | <input type="radio"/> | <input type="radio"/> | 5.530,00 € | <input type="checkbox"/> |
| Steel cradle for oversea transport without keel (only with keel not mounted) | <input type="radio"/> | <input type="radio"/> | 8.080,00 € | <input type="checkbox"/> |
| Shrink wrap | <input type="radio"/> | <input type="radio"/> | 1.300,00 € | <input type="checkbox"/> |

– Not available ■ Standard ○ Optional

Bavaria Yachtbau GmbH, Bavariastraße 1, D-97232 Giebelstadt, Phone +49 9334 942-0, Fax +49 9334 942-1160, www.bavariayachts.com, info@bavariayachts.com

All prices are in EURO and are valid only in conjunction and at the time of ordering a new yacht ex works Giebelstadt. All measurements and weights are calculations based upon design documents. The brochure is intended for advertisement only and is not part of a contract, warranty or of any offer. We reserve the right to modify or improve our products and to change specifications without notice. We reserve the right to replace the brands/manufacturers mentioned in the price list with equivalent products from other reputable manufacturers. We are not liable for errors and printing mistakes. Aforementioned prices are recommended sales prices for deliveries ex works within 4 months of order placement. Later deliveries are subject to invoicing according to the then valid price list.

Version: 1/2025

Valid from 01st August 2024

Publication: 22nd July 2024 – The previous price list loses its validity.

Language/Taxes: English pricelist/all prices excl. VAT

