



# C57



## TECHNICAL DATA (approx.)

C57

Length over all	16,67 m	54,69 ft
Length over all incl. bowsprit	17,15 m	56,26 ft
Length hull	16,16 m	53,01 ft
Length waterline	15,62 m	51,24 ft
Beam of hull	5,28 m	17,32 ft
Draught standard	2,50 m	8,20 ft
Draught option	2,00 m	6,56 ft
Ballast standard	5.215 kg	11.497 lb
Ballast option	5.455 kg	12.026 lb
Displacement with deep keel 2,5 m	18.157 kg	40.029 lb
Displacement with shallow keel 2,0 m	19.163 kg	42.247 lb
Engine (standard)	80,9 kW / 110 PS	80,9 kW / 110 hp
Engine (standard)	Yanmar 4JH110	Yanmar 4JH110
Fuel tank (approx.)	440 L	96,8 gal <sup>1)</sup>
Water tank (approx.)	540 L	118,8 gal <sup>1)</sup>
Sail area total (standard)	136,5 m <sup>2</sup>	1469,2 sq.ft
Mainsail (standard)	80,0 m <sup>2</sup>	861,1 sq.ft
Mainsail (furling mast, vertical full battens)	76,0 m <sup>2</sup>	818,7 sq.ft
Jib	56,5 m <sup>2</sup>	608,1 sq.ft
Genoa	69,0 m <sup>2</sup>	742,7 sq.ft
Gennaker	232,0 m <sup>2</sup>	2497,2 sq.ft
Code 0	123,0 m <sup>2</sup>	1323,9 sq.ft
Mast length (max.) from waterline excl. Windex	24,26 m	79,59
I	20,40 m	66,92 ft
J	6,20 m	20,34 ft
P	20,00 m	65,61 ft
E	6,88 m	22,57 ft
Cabins	3/5	3/5
Head	3/4	3/4
CE category	A15	A15
Design	Cossutti Yacht Design	
BASE PRICE EX WORKS (EXCL. VAT) – C57 HOLIDAY	525.800,00 €	
BASE PRICE EX WORKS (EXCL. VAT) – C57 STYLE	546.930,00 €	

<sup>1)</sup> [gal] imperial

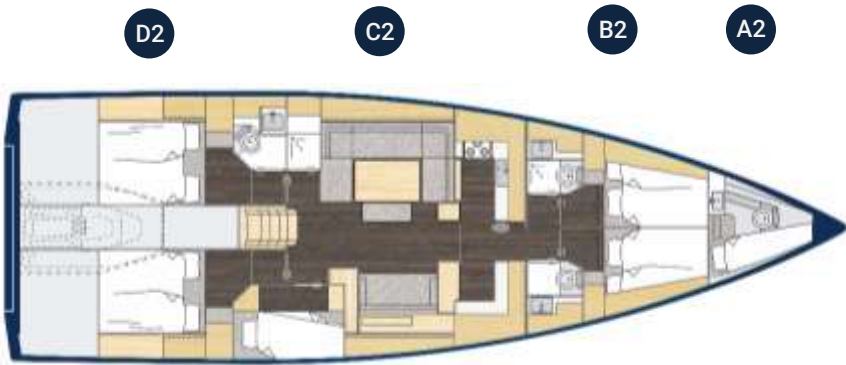
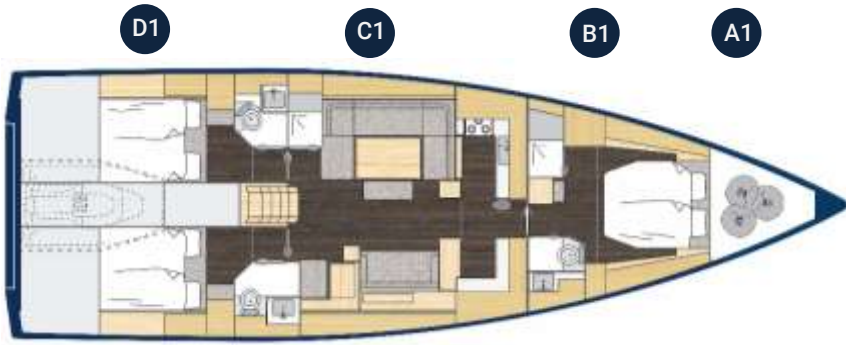

TRIM LEVEL EQUIPMENT	HOLIDAY	STYLE	C57
<b>INTERIOR STYLING</b>			
Headboard, fabric covered, in forward cabin (B1)		■	
Bed frames, fabric covered, in front and aft cabins		■	
Ceiling panels, fabric covered, in salon		■	
Chart table, leather covered		■	
Handrails, stainless steel, leather covered		■	
<b>COCKPIT &amp; DECK</b>			
Rope storage boxes, at helm position		■	
<b>INTERIOR EQUIPMENT</b>			
Reading lights incl. USB charger, salon and cabins		■	
Handrail on ceiling in stainless steel with leather cover		■	
<b>ELECTRICAL SYSTEMS</b>			
Digital Switching System incl. 12" multifunction display at chart table with GPS function	■	■	

OPTIONAL PACKAGES	HOLIDAY	STYLE	Price excl. VAT	C57
<b>SAIL READY PACK "HOLIDAY" (HP)</b>				
<b>PACKAGE CONTENTS</b>	○	—	17.390,00 €	<input type="checkbox"/>
Battery extension, 6 x service batteries 95 Ah/12 V, AGM incl. charger 60 A and 40 A, (instead of 4 x service batteries 95 Ah / 12 V, AGM, and charger 60 A) Guard rail exit, both sides Anchor windlass, electrical Anchor, 32 kg, incl. chain (10 mm, 75 m), galvanized Courtesy lights in salon Curtains for coachroof and hull windows Blinds incl. mosquito nets for hatches in salon and cabins				
Deck vents, 2 x, on deck hatches LED lights in salon and cabins Mooring kit (8 fenders and 4 mooring lines) Reading lights incl. USB charger, salon and cabins Handrail on ceiling in stainless steel Stainless steel bow protection Cockpit shower with cold and warm water				
<b>UPGRADES SAIL READY PACK "HOLIDAY" (HP-U)</b>				
Bow thruster, tunnel, incl. additional battery 2 x 95 Ah / 12 V, AGM	○	—	10.120,00 €	<input type="checkbox"/>
Lithium Batterien, 4 x 150 Ah / 12V, LiFePO4 anstelle der AGM Service Batterien	○	—	10500,00 €	<input type="checkbox"/>
Anchor, 32 kg, incl. chain (10 mm, 75 m), stainless steel	○	—	5.340,00 €	<input type="checkbox"/>
Anchor windlass with capstans	○	—	1.430,00 €	<input type="checkbox"/>
<b>SAIL READY PACK "STYLE" (SP)</b>				
<b>PACKAGE CONTENTS</b>	—	○	33.300,00 €	<input type="checkbox"/>
Bow thruster, tunnel, incl. additional battery 2 x 95 Ah / 12 V, AGM Teak on cockpit bottom Battery extension, 6 x service batteries 95 Ah/12 V, AGM incl. charger 60 A and 40 A, (instead of 4 x service batteries 95 Ah / 12 V, AGM, and charger 60 A) Guard rail exit, both sides Anchor windlass, electrical Anchor, 32 kg, incl. chain (10 mm, 75 m), galvanized Courtesy lights in salon and cockpit Curtains for coachroof and hull windows Blinds incl. mosquito nets for hatches in salon and cabins				
Deck vents, 2 x, on deck hatches LED lights in salon and cabins Mooring kit (8 fenders and 4 mooring lines) Ambient lights in salon and cabins, dimmable Extractor hood in galley Halyard winches, 2 pc., size 65, manual Cockpit table with small storage, 2 x, electrical lowerable to sun bathing area Cockpit shower with cold and warm water				
<b>UPGRADES SAIL READY PACK "STYLE" (SP-U)</b>				
Bow thruster, retractable, incl. additional battery 2 x 95 Ah / 12 V, AGM	—	○	9.990,00 €	<input type="checkbox"/>
Lithium Batterien, 4 x 150 Ah / 12V, LiFePO4 anstelle der AGM Service Batterien	—	○	10.500,00 €	<input type="checkbox"/>
Esthec on cockpit bottom	—	○	1.140,00 €	<input type="checkbox"/>
Anchor, 32 kg, incl. chain (10 mm, 75 m), stainless steel	—	○	5.340,00 €	<input type="checkbox"/>

Anchor windlass with capstans	–	○	1.430,00 €	<input type="checkbox"/>
Halyard winches, 2 x, size 65, electrical	–	○	6.450,00 €	<input type="checkbox"/>
<b>NAVIGATION PACKAGES</b>				
<b>NAVIGATION PACKAGE "BASIC"</b>	○	–	12.110,00 €	<input type="checkbox"/>
Instrument console (1 x per helm station) Display, 2 x B&G Triton <sup>2</sup> digital displays in cockpit; B&G Wind vane; DST800 Transducer for speed, depth and temperature Multi function display, B&G Zeus <sup>3</sup> S 9" with integrated GoFree™ Wi-Fi; all-weather touch screen and expanded keypad	VHF, B&G V60 with integrated AIS Receiver at chart table Autopilot B&G, incl. compass Autopilot B&G, control unit at helmstation stb Autopilot B&G, wireless remote control WR10			
<b>NAVIGATION PACKAGE „ADVANCED“</b>	○	○	20.160,00 €	<input type="checkbox"/>
Instrument console (1 x per helm station) Display, 4 x B&G Triton <sup>2</sup> digital displays in cockpit; B&G Wind vane; DST800 Transducer for speed, depth and temperature Multi function display, 2 x B&G Zeus <sup>3</sup> S 9" with integrated GoFree™ Wi-Fi; all-weather touch screen and expanded keypad, one per helm station	VHF, B&G V60 with integrated AIS Receiver at chart table VHF, B&G H60 wireless handset Autopilot B&G, incl. compass Autopilot B&G, control unit at helmstation stb Autopilot B&G, wireless remote control WR10			
<b>NAVIGATION PACKAGE "PREMIUM"</b>	–	○	26.150,00 €	<input type="checkbox"/>
Instrument console (1 x per helm station) Display, 2 x B&G H5000 graphic displays (1 x per helmstation); B&G Wind vane; DST800 Transducer for speed, depth and temperature Multi function display, 2 x B&G Zeus <sup>3</sup> S 12" with integrated GoFree™ Wi-Fi; all-weather touch screen and expanded keypad, one per helmstation NMEA engine information interface for chart plotter	VHF, B&G V60 with integrated AIS Receiver at chart table VHF, B&G H60 wireless handset Autopilot B&G, incl. compass Autopilot B&G, H5000 controll unit (1 x per helmstation) Autopilot B&G, Triton Edge Sailing Processor Autopilot B&G, wireless remote control WR10			
<b>UPGRADES ELECTRONIC NAVIGATION PACKAGE</b>				
Radar B&G Halo 20+	○	○	3.840,00 €	<input type="checkbox"/>
Depth sounder, B&G ForwardScan	–	○	1.760,00 €	<input type="checkbox"/>
AIS transponder, B&G NAIS-400 class B transponder	○	○	1.530,00 €	<input type="checkbox"/>
<b>ENTERTAINMENT PACKAGE "BASIC"</b>				
<b>PACKAGE CONTENTS</b>	○	○	2.980,00 €	<input type="checkbox"/>
Radio entertainment system Fusion MS-RA770 Apollo Marine with DAB+ and 2 speakers in salon	Fusion ERX400 Apollo remote control with 2 speakers in cockpit			
<b>UPGRADES ENTERTAINMENT PACKAGE "BASIC"</b>				
ENTERTAINMENT PACKAGE "OWNER" Radio entertainment system Fusion MS-R670 and 2 speakers in foreship cabin (only with B1)	–	○	1.230,00 €	<input type="checkbox"/>
TV preparation in salon, incl. TV lift system	○	○	2.140,00 €	<input type="checkbox"/>

INDIVIDUAL OPTIONS		HOLIDAY	STYLE	Price excl. VAT	C57
<b>HULL / KEEL</b>					
<b>STANDARD</b>					
Hull in sandwich construction		Keel, L-shape, cast iron, draft 2,52 m			
<b>OPTIONS</b>					
Hull colour, white	■	■	Standard	<input type="checkbox"/>	
Hull colour silk grey with hull stripe white	○	○	6.800,00 €	<input type="checkbox"/>	
Hull stripe, dark blue	■	○	1.720,00 €	<input type="checkbox"/>	
Hull stripe, silk grey	○	■	1.720,00 €	<input type="checkbox"/>	
Hull stripe, dark grey	○	○	1.720,00 €	<input type="checkbox"/>	
Hull stripe, jet black	○	○	1.720,00 €	<input type="checkbox"/>	
Keel, L-shape, cast iron, draft 1,99 m	○	○	3.920,00 €	<input type="checkbox"/>	
<b>PROPULSION &amp; STEERING SYSTEM</b>					
<b>STANDARD</b>					
Diesel, 81 kW / 110 hp, shaft drive 3 blade fixed propeller Engine throttle, mechanical, mounted on helm station starboard		Twin wheel steering system GRP twin rudder with aluminum stock Steering wheel, stainless steel with leather cover			
<b>OPTIONS</b>					
Engine throttle, electric, mounted on steering pedestal stb. (only with navigation package)	○	○	8.520,00 €	<input type="checkbox"/>	
Engine throttle, electric, mounted on steering pedestal ps. (only with engine throttle, electric stb)	○	○	4.520,00 €	<input type="checkbox"/>	
Propeller, folding, 3 blades	○	○	2.740,00 €	<input type="checkbox"/>	
Stern thruster incl. 2 x 95 Ah battery, retractable (only with bow thruster retractable)	–	○	19.090,00 €	<input type="checkbox"/>	
Steering wheel, composite, black or white	○	○	1.950,00 €	<input type="checkbox"/>	
Steering wheels covers	–	○	1.160,00 €	<input type="checkbox"/>	
<b>STANDING AND RUNNING GEAR</b>					
<b>STANDARD</b>					
Conventional mast, keel stepped, 2 spreader, aluminum Jib furling system, above deck, manual Rod kicker Backstay adjuster, hydraulic		Midboom sheeting system Elvström Cruisetech Dacron - Mainsail, short battened with 2 reefs - self tacking jib, no battens Halyard winches, 2 x, size 55, manual			
<b>OPTIONS CONVENTIONAL MAST</b>					
Elvström Cruisetech Dacron - Mainsail, full battened with 2 reefs and MDS slider (replacing standard main sail)	○	○	1.670,00 €	<input type="checkbox"/>	
Elvström Ekko-Tech laminate - Mainsail, full battened with 2 reefs and MDS slider- self tacking jib, vertical battened	○	○	10.500,00 €	<input type="checkbox"/>	
Lazy bag with lazy jacks for mainsail	○	○	1.780,00 €	<input type="checkbox"/>	
<b>OPTIONS FURLING MAST</b>					
Furling mast, keel stepped 2 spreader, aluminium incl. upgrade to Cruisetech Dacron furling mainsail.	○	○	4.610,00 €	<input type="checkbox"/>	
Furling mast, electrical, keel stepped, 2 spreader, aluminium incl. upgrade to Cruisetech Dacron furling mainsail. Jib furling system, electrical. Synchronized electrical halyard winch Selden E60 on ps, electrical halyard winch Lewmar Evo AEST 65.	○	○	40750,00 €	<input type="checkbox"/>	
Elvström Cruisetech Dacron UPGRADE – furling mainsail, vertically full battened – self-tacking jib	○	○	2.240,00 €	<input type="checkbox"/>	
Elvström Ekko-Tech laminate - furling mainsail, vertically full battened - self-tacking jib with vertical battens	○	○	11.450,00 €	<input type="checkbox"/>	
<b>OPTIONS STANDING AND RUNNING GEAR</b>					
Elvström genoa 106% - Cruisetech Dacron (only with genoa tracks)	○	○	5.628,00 €	<input type="checkbox"/>	
Elvström genoa 106%, vertical batten - Ekko-Tech (only with genoa tracks)	○	○	7.371,00 €	<input type="checkbox"/>	
Genoa tracks with pin stop cars	○	○	1.990,00 €	<input type="checkbox"/>	
Elvström gennaker incl. snuffer and gennaker gear (halyard, sheets, blocks, halyard clutch and pad eye)	○	○	8.750,00 €	<input type="checkbox"/>	
Elvström permanent Code 0 and gear (halyard, sheets, blocks, halyard clutch and pad eye for code 0 tack / only with bowsprit)	○	○	10.550,00 €	<input type="checkbox"/>	
Mast step	○	○	740,00 €	<input type="checkbox"/>	

Spreader lights, 4 pcs.	–	○	1.660,00 €	<input type="checkbox"/>
GRP bowsprit (black or white / recommended for gennaker and code 0)	○	○	4.940,00 €	<input type="checkbox"/>
Organizer at halyard winches	–	○	2.650,00 €	<input type="checkbox"/>

#### OPTIONS WINCHES

Halyard winches, 2 x, size 65, manual	○	○	2.840,00 €	<input type="checkbox"/>	SP
Halyard winches, 2 x, size 65, electrical	○	○	6950,00 €	<input type="checkbox"/>	SP-U
Genoa/gennaker/code0 winches, 2 x, size 55, manual	○	○	3.440,00 €	<input type="checkbox"/>	
Genoa winches, 2 x, size 65, manual	○	○	4.650,00 €	<input type="checkbox"/>	
Genoa winches, 2 x, size 65, electrical	○	○	9.250,00 €	<input type="checkbox"/>	

#### DECK FLOORING

##### STANDARD

Teak on cockpit benches and bathing platform

##### OPTIONS

Teak on cockpit bottom	○	○	6.030,00 €	<input type="checkbox"/>	SP
Teak on side decks	○	○	22.380,00 €	<input type="checkbox"/>	
Teak on coachroof	–	○	8.390,00 €	<input type="checkbox"/>	
Esthec on cockpit benches and bathing platform	○	○	2.800,00 €	<input type="checkbox"/>	
Esthec on cockpit bottom	○	○	6.000,00 €	<input type="checkbox"/>	
Esthec on side decks	○	○	22.200,00 €	<input type="checkbox"/>	
Esthec on coachroof	–	○	8.300,00 €	<input type="checkbox"/>	

#### COCKPIT & DECK

##### STANDARD

Deck in sandwich construction, cockpit floor, side decks and coach roof with non-slip structure  
Deck flush hatches  
Cockpit table with small storage, 2 x, fix

Dedicated life raft storage in cockpit floor  
Bow fitting with anchor roller, stainless steel  
Mooring cleats, 6 x, stainless steel, fix

##### OPTIONS COCKPIT & DECK

Cockpit tables with small storage, 2 x, electrical, lowerable to sun bathing area	–	○	4.620,00 €	<input type="checkbox"/>	SP
Drawer fridge incl. compressor at wet bar, 20 L (only in combination with E2 and BBQ)	○	○	1.690,00 €	<input type="checkbox"/>	
BBQ (gas) with sink and water tap in wet bar (only in combination with E2)	○	○	2.620,00 €	<input type="checkbox"/>	
Guard rail exit, both sides	○	○	1.420,00 €	<input type="checkbox"/>	HP, SP
Guard rail exit ladder, aluminium	○	○	790,00 €	<input type="checkbox"/>	
Teak pushpit seats, foldable	–	○	1.430,00 €	<input type="checkbox"/>	
Mooring cleats, 6 x, aluminum, retractable	–	○	4.590,00 €	<input type="checkbox"/>	
Stainless steel bow protection	○	○	570,00 €	<input type="checkbox"/>	HP
LFS - safety package	○	○	360,00 €	<input type="checkbox"/>	
Live saving collar with attachment and life line at pushpit	○	○	430,00 €	<input type="checkbox"/>	

##### OPTIONS COCKPIT UPHOLSTERY

Cockpit cushions incl. backrests	–	○	5.620,00 €	<input type="checkbox"/>	
Sun bed cushions on coachroof incl. headrest and cup holders	○	○	2.150,00 €	<input type="checkbox"/>	
Sun bed cushions on foredeck incl. headrest and cup holders	○	○	2.260,00 €	<input type="checkbox"/>	

##### OPTIONS HOODS

Bimini top	○	○	5.050,00 €	<input type="checkbox"/>	
Bimini top with solar panels, 348 Wp	○	○	8.950,00 €	<input type="checkbox"/>	
Sprayhood with handhold	○	○	3.700,00 €	<input type="checkbox"/>	
Cockpit tables cover	–	○	1.070,00 €	<input type="checkbox"/>	

#### BATHING PLATFORM

##### STANDARD

Bathing platform, electric

##### OPTIONS

Tender launching system (incl. rollers and electrical winch, only with E2 dinghy garage)	○	○	5.860,00 €	<input type="checkbox"/>	
--	---	---	------------	--------------------------	--

Wireless remote control for bathing platform	○	○	1.580,00 €	<input type="checkbox"/>
12 V air compressor at transom for dinghy or toys (only with E2 Layout)	○	○	920,00 €	<input type="checkbox"/>

## INTERIOR LAYOUT

### STANDARD

A1: Sail locker	E1: Storage space for toys and equipment under cockpit, access via cockpit floor hatch
B1: Queen size "island" double berth, storage, separate head and shower stall	Companion way with washboard and sliding hatch in acrylic glass, lockable
C1: Salon incl. U shaped galley, dining area on port, lounge area and chart table on stb (only with D1)	Salon dining table
D1: 2 Twin cabins with "scissor" bed aft, incl. ensuite head and separate shower stall on port and separate head on stb (only with C1)	

### OPTIONS

A2: Crew cabin with sink, toilet and storage space, 25 L holding tank	○	○	7.890,00 €	<input type="checkbox"/>
B2: 2 Forward cabins, each cabin with double bed and storage, flex bulkhead system, 2 heads	○	○	8.640,00 €	<input type="checkbox"/>
C2: Salon incl. galley, dining area on port and lounge area on stb (only with D2, D3)	○	○	no charge	<input type="checkbox"/>
D2: 2 Aft cabins, incl. separate head and shower stall on port and bunk cabin stb (only with C2)	○	○	1.660,00 €	<input type="checkbox"/>
D3: 2 Aft cabins, incl. separate head and shower stall on port and utility room stb (only with C2)	○	○	1.660,00 €	<input type="checkbox"/>
E2: Dinghy garage, large longitudinal version (max. 2,8 m jet tender)	○	○	5.250,00 €	<input type="checkbox"/>
Additional bunk bed for A2 layout (180 cm)	○	○	2.210,00 €	<input type="checkbox"/>
Salon table, lowerable, electrical, convertible into double berth incl. cushion	○	○	3.460,00 €	<input type="checkbox"/>
Director's chair, 2 x (replacing bench in salon)	—	○	1.970,00 €	<input type="checkbox"/>

## INTERIOR STYLING

### STANDARD

Wood color, Mahogany	Upholstery "Vela" in salon
Floor, Elm	Standard mattresses for all berths
Worktop in galley, laminated, "Brown stone"	

### OPTIONS STYLING

Wood color, Mahogany	■	■	Standard	<input type="checkbox"/>
Wood color, American Walnut	○	○	8.240,00 €	<input type="checkbox"/>
Wood color, Nordic Oak	○	○	8.980,00 €	<input type="checkbox"/>
Floor, Elm	■	■	Standard	<input type="checkbox"/>
Floor, Wenge	○	○	1.240,00 €	<input type="checkbox"/>
Floor, Ocean Line	○	○	2.110,00 €	<input type="checkbox"/>
Worktop in galley, laminated, "Pure white stone"	○	—	1.060,00 €	<input type="checkbox"/>
Worktop in galley, solid worktop "Staten Island Stone"	—	○	3.630,00 €	<input type="checkbox"/>
Worktop in galley, solid worktop "Canvas Mist"	—	○	3.630,00 €	<input type="checkbox"/>

### OPTIONS UPHOLSTERY

Upholstery "Heritage" in salon, fabric	○	○	1.660,00 €	<input type="checkbox"/>
Upholstery "Opus" in salon, artificial leather	○	○	1.760,00 €	<input type="checkbox"/>
Upholstery "Savoy" in salon, leather	—	○	6.200,00 €	<input type="checkbox"/>
Cold foam mattress with memory top for all berths 3 cabins	○	○	3.700,00 €	<input type="checkbox"/>
Cold foam mattress with memory top for all berths 4 cabins	○	○	3.920,00 €	<input type="checkbox"/>
Cold foam mattress with memory top for all berths 5 cabins	○	○	4.150,00 €	<input type="checkbox"/>



## INTERIOR EQUIPMENT – GALLEY

### STANDARD

Fridge in galley, 110L, top loading 3 burner stove with oven

### OPTIONS

Microwave, 230 V, (powered by Generator or Shore-Power)	<input type="radio"/>	<input type="radio"/>	780,00 €	<input type="checkbox"/>
Microwave preparation, 110V, (powered by Generator or Shore-Power)	<input type="radio"/>	<input type="radio"/>	410,00 €	<input type="checkbox"/>
Dishwasher drawer 230 V (not in combination with cooled and sparkling water)	<input type="radio"/>	<input type="radio"/>	3.800,00 €	<input type="checkbox"/>
Drawer fridge incl. Freezer unit totalling 160 L (replacing standard fridge)	<input type="radio"/>	<input type="radio"/>	3.660,00 €	<input type="checkbox"/>
Fridge in galley	<input type="radio"/>	<input type="radio"/>	1.780,00 €	<input type="checkbox"/>
Dedicated space for coffee machine incl. 220 V socket	<input type="radio"/>	<input type="radio"/>	260,00 €	<input type="checkbox"/>
Purified drinking water with UVC-LED technology in pantry	<input type="radio"/>	<input type="radio"/>	1.350,00 €	<input type="checkbox"/>
Cooled and sparkling water at the pantry tap (only with purified drinking water - not in combination with dishwasher drawer, only with 230V, powered by Generator or Shore-Power)	<input type="radio"/>	<input type="radio"/>	2.790,00 €	<input type="checkbox"/>

## INTERIOR EQUIPMENT – ELECTRICAL SYSTEM

### STANDARD

Country version EU Service battery, 4 x 95 Ah / 12 V, AGM  
 230 V socket in each cabin Battery charger, 60 Ah (3 channels)  
 Engine battery, 1 x 96 Ah / 12 V, AGM Shore power 230 V

### OPTIONS

Battery extension, additional service battery, 2 x 95 Ah /12 V, AGM incl. additional charger 40 A	<input type="radio"/>	<input type="radio"/>	1.160,00 €	<input type="checkbox"/>	HP, SP
Inverter 2.500 W, 230 V (true sine wave)	<input type="radio"/>	<input type="radio"/>	3.400,00 €	<input type="checkbox"/>	
Inverter 2.000 W, 110 V (true sine wave)	<input type="radio"/>	<input type="radio"/>	3.400,00 €	<input type="checkbox"/>	
Diesel generator 6,4 kW, 230 V	<input type="radio"/>	<input type="radio"/>	23.740,00 €	<input type="checkbox"/>	
Diesel generator 8,0 kW, 230 V (recommended for Air conditioning)	<input type="radio"/>	<input type="radio"/>	27.990,00 €	<input type="checkbox"/>	
Diesel generator 6,4 kW, 110 V	<input type="radio"/>	<input type="radio"/>	28.190,00 €	<input type="checkbox"/>	
Diesel generator 8,0 kW, 110 V (recommended for Air conditioning)	<input type="radio"/>	<input type="radio"/>	32.440,00 €	<input type="checkbox"/>	
Shore power 110 V	<input type="radio"/>	<input type="radio"/>	4.220,00 €	<input type="checkbox"/>	

## INTERIOR EQUIPMENT – WATER

### STANDARD

40 L boiler Electric and manual bilge pump  
 70 L holding tank, per toilet

### OPTIONS

Fresh water dockside inlet	<input type="radio"/>	<input type="radio"/>	560,00 €	<input type="checkbox"/>
Watermaker, 100 L/h, 12 V	<input type="radio"/>	<input type="radio"/>	16.500,00 €	<input type="checkbox"/>
Washer/dryer, 6 kg, 220 V (only with D3 layout), (powered by Generator or Shore-Power)	<input type="radio"/>	<input type="radio"/>	3.120,00 €	<input type="checkbox"/>
Washing machine, only preparation 110 V (incl. grey water tank, only with D3 layout), (powered by Generator or Shore-Power)	<input type="radio"/>	<input type="radio"/>	1.870,00 €	<input type="checkbox"/>
Electric toilet (1 x) front cabin with fresh water flush system for B1 layout	<input type="radio"/>	<input type="radio"/>	1.250,00 €	<input type="checkbox"/>
Electric toilet (2 x) front cabin with fresh water flush system for B2 layout	<input type="radio"/>	<input type="radio"/>	2.490,00 €	<input type="checkbox"/>
Electric toilet (2x) aft cabin with fresh water flush system for D1 or D3 layout	<input type="radio"/>	<input type="radio"/>	2.490,00 €	<input type="checkbox"/>
Electric toilet (1 x) aft cabin with fresh water flush system for D2 Layout	<input type="radio"/>	<input type="radio"/>	1.250,00 €	<input type="checkbox"/>
Grey water system, totalling 180 L	<input type="radio"/>	<input type="radio"/>	4.090,00 €	<input type="checkbox"/>

## INTERIOR EQUIPMENT – CLIMATE CONTROL (HEATING AND AIR CONDITIONER ARE NOT COMBINABLE)

### OPTIONS

Air Conditioner, Reverse Cycle, 22.000 BTU, 2 Units for foreship cabin and aft cabins, 230 V / 110 V (with 230V: incl. 2nd shore power)	<input type="radio"/>	<input type="radio"/>	19.500,00 €	<input type="checkbox"/>
Air Conditioner, Reverse Cycle, 16.000 BTU, 2 Units for salon (incl. D2 cabin), 230 V / 110 V (with 230V: incl. 2nd shore power)	<input type="radio"/>	<input type="radio"/>	15.990,00 €	<input type="checkbox"/>
Hot air heating, 8,0 kW, 2 Units for salon, foreship cabin(s) and aft cabins	<input type="radio"/>	<input type="radio"/>	9.060,00 €	<input type="checkbox"/>



## SHIPMENT

### OPTIONS

Keel not mounted	<input type="radio"/>	<input type="radio"/>	630,00 €	<input type="checkbox"/>
Steel cradle for oversea transport	<input type="radio"/>	<input type="radio"/>	8.530,00 €	<input type="checkbox"/>
Steel cradle for oversea transport without keel (only with keel not mounted)	<input type="radio"/>	<input type="radio"/>	10.670,00 €	<input type="checkbox"/>
Shrink wrap	<input type="radio"/>	<input type="radio"/>	1.410,00 €	<input type="checkbox"/>

— Not available   ■ Standard   ○ Optional

Bavaria Yachtbau GmbH, Bavariastraße 1, D-97232 Giebelstadt, Phone +49 9334 942-0, Fax +49 9334 942-1160, [www.bavariayachts.com](http://www.bavariayachts.com), [info@bavariayachts.com](mailto:info@bavariayachts.com)

All prices are in EURO and are valid only in conjunction and at the time of ordering a new yacht ex works Giebelstadt. All measurements and weights are calculations based upon design documents. The brochure is intended for advertisement only and is not part of a contract, warranty or of any offer. We reserve the right to modify or improve our products and to change specifications without notice. We reserve the right to replace the brands/manufacturers mentioned in the price list with equivalent products from other reputable manufacturers. We are not liable for errors and printing mistakes. Aforementioned prices are recommended sales prices for deliveries ex works within 4 months of order placement. Later deliveries are subject to invoicing according to the then valid price list.

Version: 1/2025

Valid from 01<sup>st</sup> August 2025

Publication: 22<sup>nd</sup> July 2024 – The previous price list loses its validity.

Language/Taxes: English pricelist/all prices excl. VAT

